



Sea Cliff
20 25th Avenue

20 25TH AVENUE

5 BEDS | 3.5 BATHS | 3+ PARKING | \$5,995,000

Wake up to the sounds of the Pacific Ocean at this spectacular mid-century Sea Cliff retreat. This special home was reimagined by and home to some of the city's top designers and the magazine-worthy details compete only with the stellar location — down a winding tree-lined street just steps from the beach — and the Golden Gate Bridge views. Situated on an extra wide lot, the fully-detached home is nestled among mature trees and behind a gated driveway, offering privacy and a magical serenity compounded by the rolling fog and waves crashing. Every detail of 20 25th Avenue has been thoughtfully imagined, from the wide-plank wood floors, luxe and dramatic light fixtures to the custom baseboards, jaw-dropping bathrooms and four outdoor spaces.

The main level offers an expansive open floor plan with a stunning minimalist kitchen that includes a statement marble island, walk-in pantry, Gaggenau appliances and custom cabinetry. The living and dining areas feature a marble wet bar, striking black marble fireplace and wall-to-wall, floor-to-ceiling windows that frame a deck with bridge views and cherry blossoms blowing in the breeze. A walk-out deck creates a seamless transition to the outdoors.

Down a few steps from the main level are three generously-sized bedrooms with custom closets, a walk-out deck and verdant outlooks, along with a full bathroom with fun, geometric statement tile. An additional bedroom level boasts a true primary suite that includes two walk-in closets, a spa-like en-suite bathroom with radiant heat flooring, freestanding soaking tub, walk-in shower, double vanities and stunning antique brass fixtures. French doors open to a secluded deck and serene garden, perfect for a meditative morning read. Down the hall, the fifth and final bedroom is perfectly suited for guests with a separate full bathroom.

A second family room with a lounge area and built-in homework space for four opens onto a turfed yard and play area. A spacious garage with side-by-side parking includes an abundance of storage for surfboards, camping equipment or whatever gear your lifestyle commands. This exceptional home is sure to take your breath away.



Missy Wyant Smit

Founding Agent

DRE 01408017

415.203.7747

missy@missysmit.com

MissyWinsSF.com



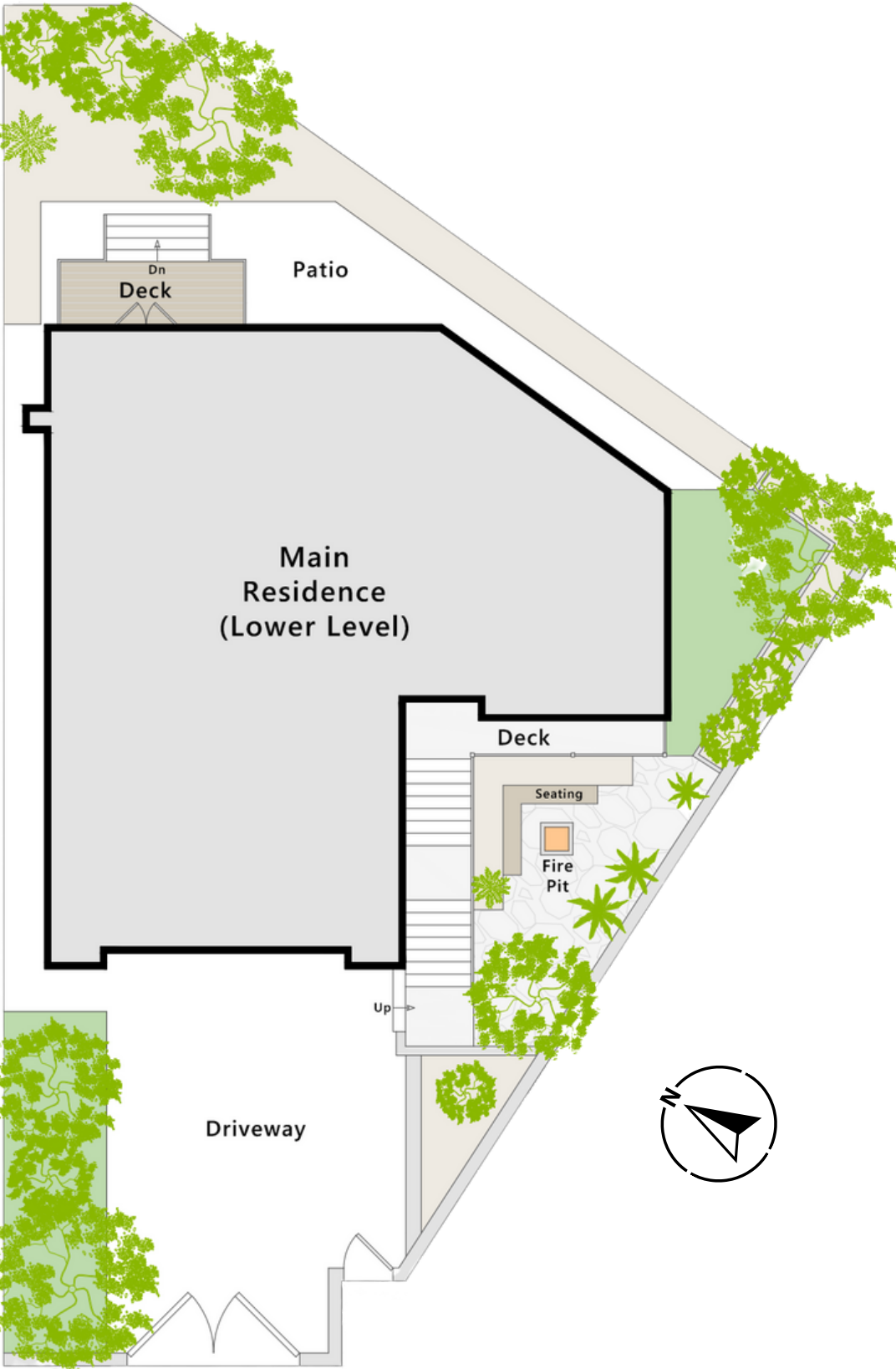

Entire Property



Lower Level



Main Level



20 25th Avenue

Sea Cliff

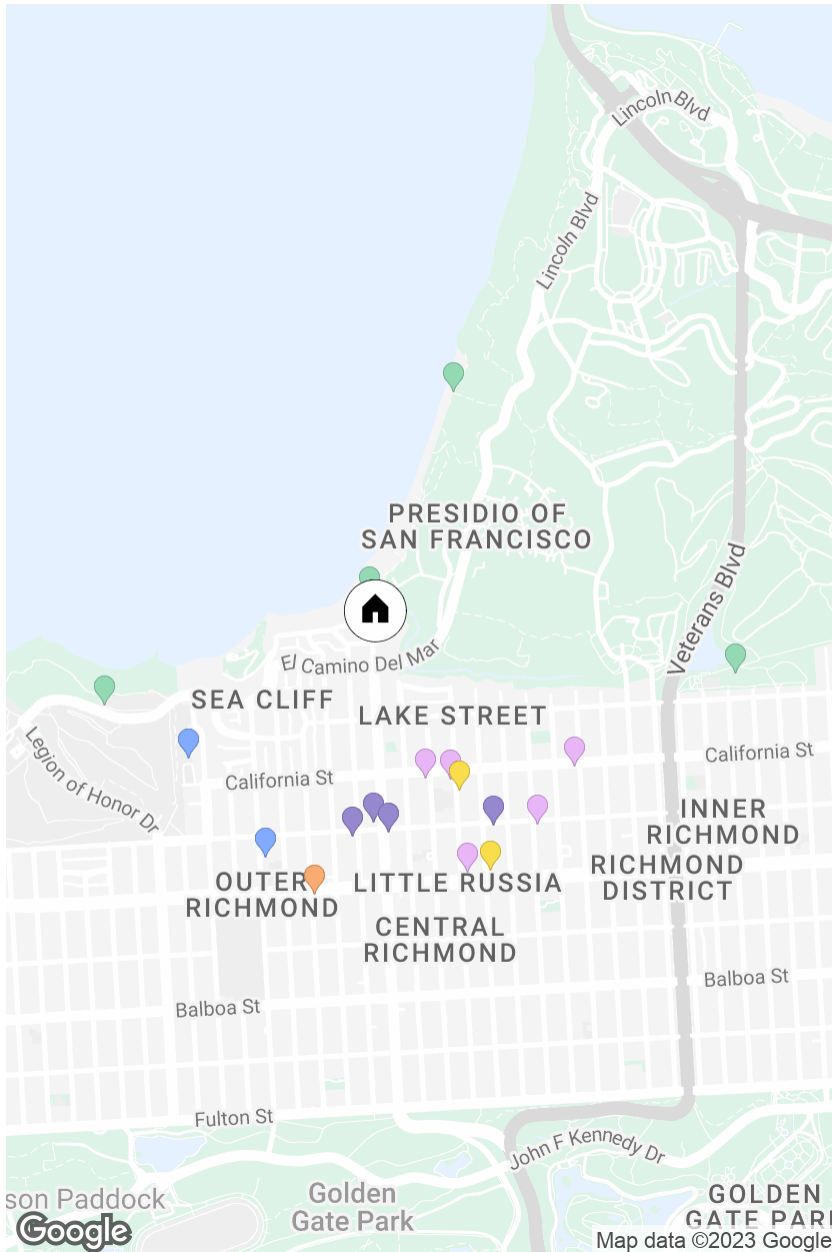

SCHOOLS

Katherine Delmar
Burke School, 0.56mi
Presidio Middle School,
0.63mi

GROCERY STORES

Grocery Outlet, 0.68mi

RESTAURANTS

Pizzetta 211, 0.41mi
Tia Margarita, 0.63mi
Firehouse Pizzeria,
0.43mi
Ham & Cheese Deli,
0.59mi
Belly, 0.65mi

PARKS

Baker Beach Sea Cliff
Access / Parking,
0.04mi

Sand Ladder at Baker
Beach, 0.54mi
Lands End Trail, 0.67mi
Mountain Lake Park,
0.86mi

GYMS

Tea & Yoga Society,
0.46mi
Hot Yoga Plus Seacliff,
0.66mi

ENTERTAINMENT

Clement Nursery,
0.57mi
Oasis Day Spa, 0.53mi
Blossom Beauty Salon,
0.50mi
Crystal Nail Spa,
0.52mi



Missy Wyant Smit

DRE #: 01408017
M: 415.203.7747
missy@missysmit.com

